

ELEVATION

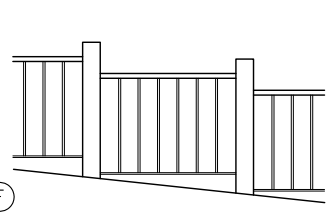

0-10% SLOPE

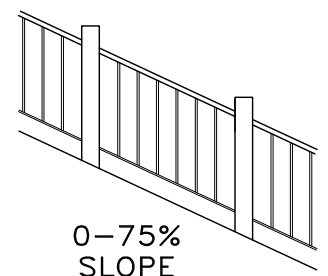

0-75% SLOPE

NOTE: PICKETS, RAILS, AND BRACKETS SHALL BE Q-36 STEEL

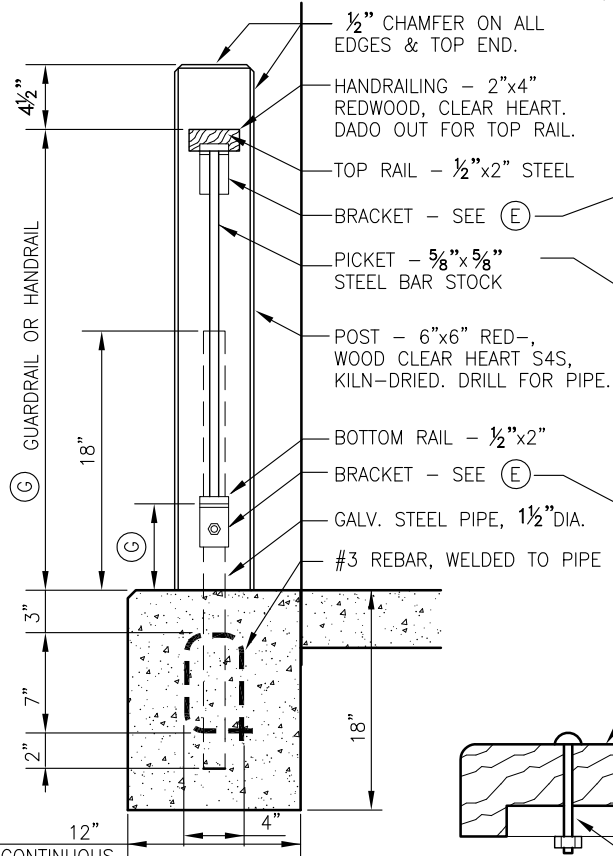

SECTION A-A

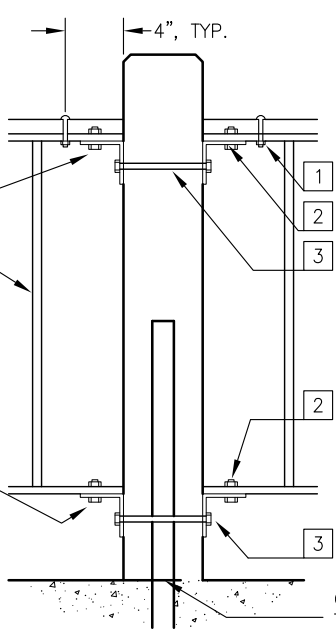

CONNECTION DETAILS

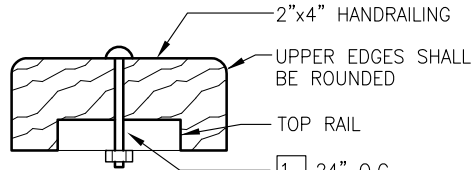
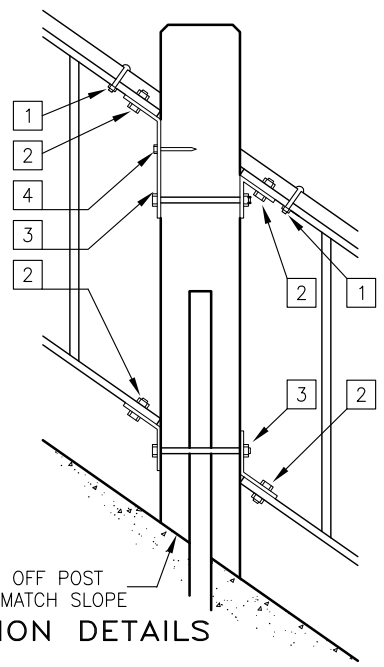

HANDRAILING

**HARDWARE**

- 1 MACHINE SCREW - 3/8" x 4", ROUNDED HEAD WITH SLOT
- 2 BOLT - 1/2" x 1 1/8"
- 3 BOLT - 1/2" x 7/8"
- 4 LAG SCREW - 3/8" x 3 1/8" (PRE DRILL)

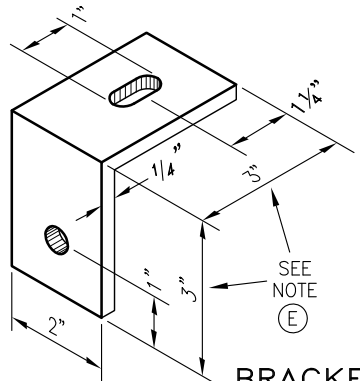

BRACKET

- NOTES:**
- (A) REDWOOD POSTS AND HANDRAILING SHALL BE FREE OF SPLITS AND SPLINTERS, SANDED SMOOTH, AND STAINED WITH 2 COATS OF BENJAMIN MOORE ACRYLIC DECK STAIN 4 BASE OR APPROVED EQUAL. COLOR: OY-2X25, BK-4X23, OG-1X22
  - (B) RAILING MAY BE STEPPED ON SLOPES OF 10% OR LESS BUT MUST BE PARALLEL TO STEEPER SLOPES.
  - (C) ALL WELDS SHALL BE FREE OF SLAG AND WIRE BRUSHED, ALL EDGES AND CORNERS OF PICKETS, RAILS, AND BRACKETS SHALL BE GROUND SMOOTH, AND ASSEMBLY SHALL BE SAND BLASTED AND PRIMED WITH A SHOP-APPLIED PRIMER (SUCH AS RUSTOLEUM DAMP-PROOF PRIMER) AND THEN SHALL BE GIVEN TWO (2) COATS OF SHOP-APPLIED SEMI-GLOSS BLACK ENAMEL.
  - (D) EACH THROUGH CONNECTION SHALL HAVE A BOLT/MACHINE SCREW, NUT, AND LOCK WASHER. ALL FASTENERS SHALL HAVE A BLACK FINISH AND MEET ASTM A307 STANDARDS.
  - (E) BRACKETS SHALL BE FABRICATED AS SHOWN AND HAVE AN OBLONG HOLE ON ONE ARM (FOR FIELD ADJUSTMENT). BRACKET ARM LENGTH & ANGLES MAY VARY DEPENDING ON SLOPE. BRACKETS SHALL BE ARRANGED TO MINIMIZE USE OF LONG BOLTS, AND TOP RAIL BRACKETS SHALL ONLY POINT DOWN. LAG SCREWS SHALL BE USED IF BRACKET ARM LENGTH EXCEEDS 5 1/2".
  - (F) AT ENDS AND CORNERS USE LARGE WASHER AND NUT, COUNTERSINK, PLUG, AND FINISH TO MATCH.
  - (G) HEIGHT AND SPACING SHALL CONFORM TO CURRENT UBC REQUIREMENTS.

REVISIONS	BY	APP	DATE
Footing demensions	SR	JDW	10-03
Mach. screw at handrail	JDL	JDW	10-02
New stain color	DVB	BL	12-08
STANDARD CURRENT AS OF:		January 2010	



MISSION STYLE RAILING  
HANDRAIL & GUARDRAIL

4240